

7. Retail and Documentation Solutions

7.1 e-BRIDGE Global Print Cloud Printing Service Allowing Mobile Devices to Log Into Multifunction Peripherals (MFP) and Reprint Same Documents

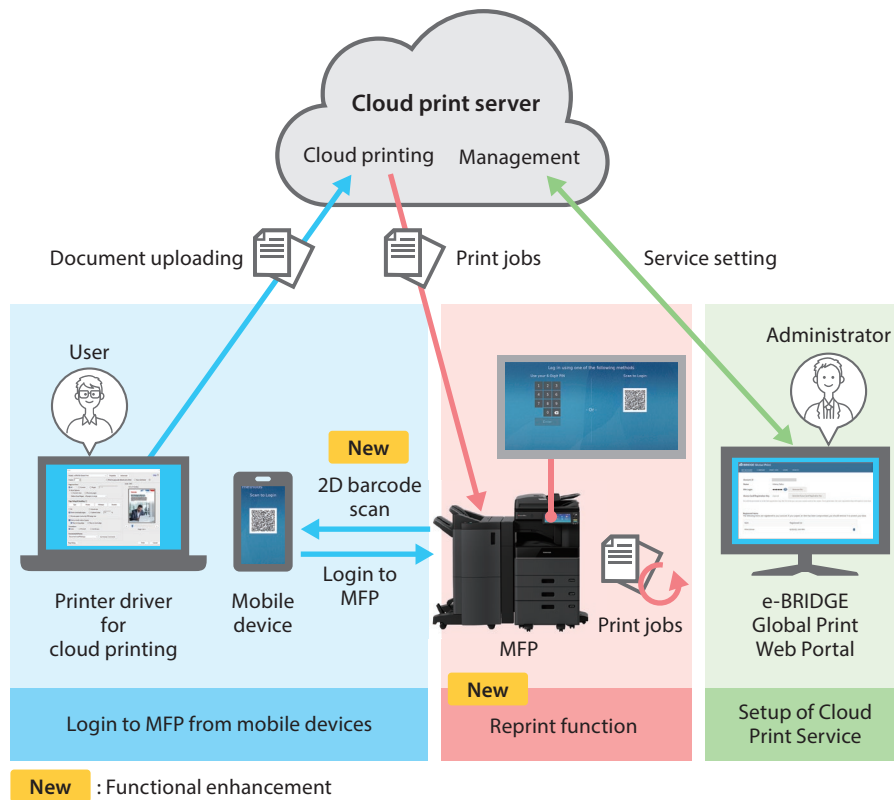

Overview of e-BRIDGE Global Print with improved login and reprinting convenience

The e-BRIDGE Global Print cloud printing service, which Toshiba Tec Corporation launched as the first step in promoting cloud services, features the ability to print documents from any multifunction peripheral (MFP) connected to the Internet. We have now added the following enhancements to e-BRIDGE Global Print to improve convenience.

- **Login to an MFP from mobile devices:** Users can now log into an MFP by scanning a two-dimensional (2D) barcode displayed on the MFP with their mobile device, eliminating the need to enter a login personal identification number (PIN).
- **Reprint function:** This function allows users to reprint a document multiple times via an MFP operation only without executing the print operation from the client.

We will add more enhancements such as features to improve output management and simplify user administrators' setup tasks and continue with efforts to promote this service to small- to medium-sized businesses, which are our main customers.